

DriveRight[®]
GPS/Wireless Interface
Module Installation Manual

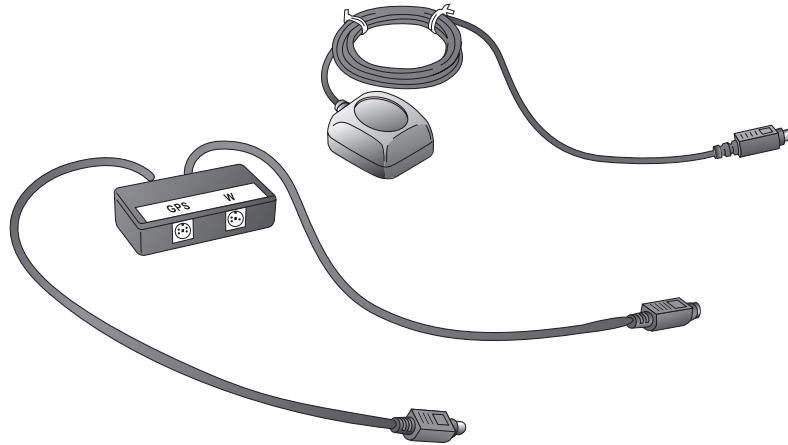

Includes:

GPS/Wireless Interface Module (#8127)

GPS Module (#8128)

Regulatory Compliance

E Mark

This Product complies with the essential protection requirements of the EC EMC Vehicle Directive 95/54/EC.

FCC Part 15 Class B Registration Warning

This equipment has been tested and found to comply with the limits for a Class B digital device, pursuant to Part 15 of the FCC Rules. These limits are designed to provide reasonable protection against harmful interference in a residential installation. This equipment generates, uses, and can radiate radio frequency energy and, if not installed and used in accordance with the instructions, may cause harmful interference to radio communications.

However, there is no guarantee that interference will not occur in a particular installation. If this equipment does cause harmful interference to radio or television reception, which can be determined by turning the equipment on and off, the user is encouraged to try to correct the interference by one or more of the following measures:

- Reorient or relocate the receiving antenna.
- Increase the separation between the equipment and receiver.
- Connect the equipment into an outlet on a circuit different from that to which the receiver is connected.
- Consult the dealer or an experienced radio/TV technician for help.

Changes or modification not expressly approved in writing by Davis Instruments may void the warranty and void the user's authority to operate this equipment.

IC: 378810-6328

EC EMC Compliance

This product complies with the essential protection requirements of the EC EMC Directive 89/336/EC.

For Products: #8127, 8128

Rev. A (5/16/06)

Davis Instruments Part Number: 7395.221 **GPS/Wireless Interface Module Installation Manual**

© Davis Instruments Corp. 2006. All rights reserved.

This product complies with the essential protection requirements of the EC EMC Directive 89/336/EC.

DriveRight® is a registered trademark of Davis Instruments Corp. Velcro® is a trademark of Velcro Industries, Manchester, NH.



3465 Diablo Avenue, Hayward, CA 94545-2778 U.S.A.

510-732-9229 • Fax: 510-732-9188

E-mail: info@davisnet.com • www.davisnet.com

GPS\Wireless Interface Module Installation Manual

This manual provides the instructions necessary to install the DriveRight GPS\Wireless Interface Module (#8127) and GPS Module (#8128) with your DriveRight 600E device. The GPS\Wireless Interface Module is also used in conjunction with the Wireless Download Module (#8129).

Note: At time of publication, the Wireless Download Module (#8129) is still under development. Please contact your DriveRight reseller or Davis Instruments for more information on its availability.

Refer to the *DriveRight 600 User's Guide*, *DriveRight 600E Addendum*, and the *DriveRight Software Online Help* for instructions on how to configure and use your GPS Module.

Note: The GPS Module (#8128) is only compatible with the DriveRight 600E device (#8126). It cannot be used with older DriveRight devices.

Components and Mounting Hardware

The GPS\Wireless Interface Module (#8127) should come with the component and mounting hardware shown below:

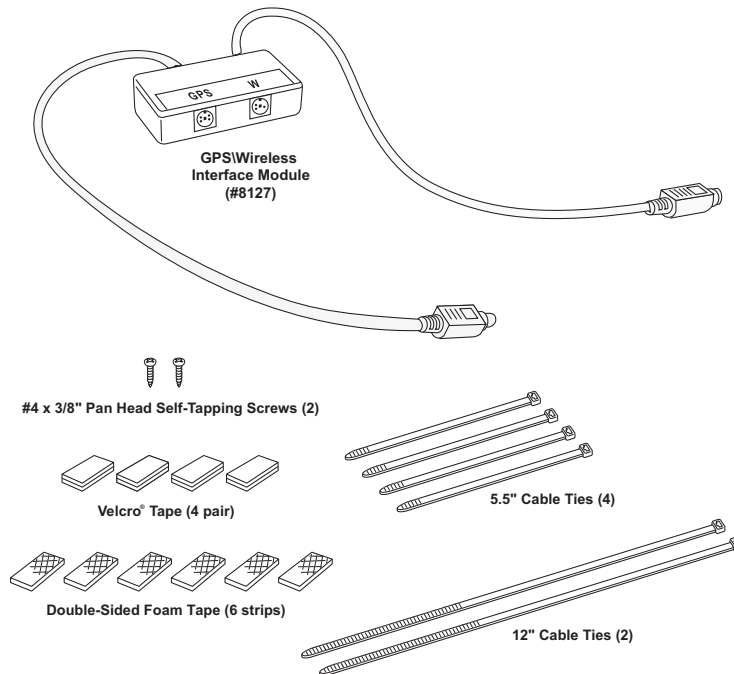

The GPS Module (#8128) is sold separately and comes with the component shown below:

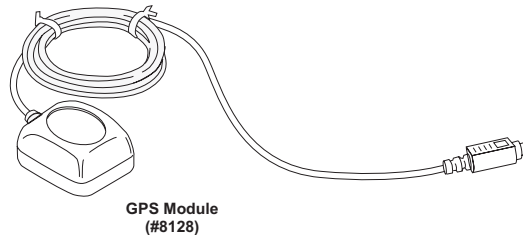

Installing the GPS\Wireless Interface Module

1. Place the GPS\Wireless Interface Module under the dashboard of the vehicle, near the DriveRight 600E device or SmartCard On-Board Reader.
2. Secure the GPS\Wireless Interface Module in place using the provided cable ties, velcro tape, or double-sided tape.

Installing the GPS Module

1. Mount the GPS module on top of the dashboard:
 - Locate the module so that it has a clear view of the sky. Any metal obstructions may interfere with satellite reception.
 - The module must be at least three (3) feet away from any cellular or CB antenna. Close proximity to a transmitting antenna may degrade or disrupt GPS reception.
2. Secure module by using double-sided tape, velcro, or magnetic mounting.

Note: Davis does not recommend magnetic mounting outside of the vehicle.

3. Route the GPS Module cable to the GPS\Wireless Interface Module.

Making Connections

1. Connect the GPS Module to the GPS\Wireless Interface Module by plugging the male connector into the socket labeled “GPS”.
2. Disconnect the DriveRight 600E device or SmartCard On-Board Reader cable from the Digital Input Adapter Cable.
3. Connect the male connector from the GPS/Wireless Interface Module cable to the female connector from the Digital Adapter Cable.

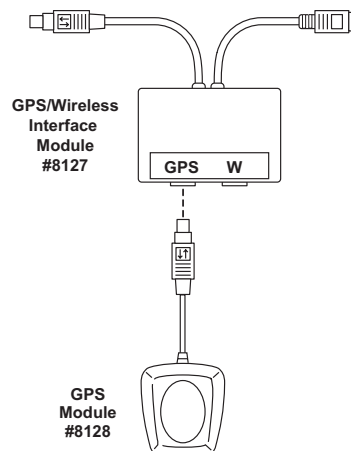

4. Connect the female connector from the GPS/Wireless Interface Module to the Male connector from the DriveRight 600E or SmartCard On-Board Reader if present.

See the diagrams below for help on disconnecting and connecting the cables properly:

Disconnecting Cables:

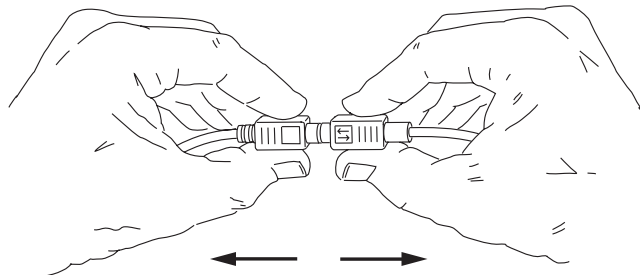

*Hold both cables by their connector housing and pull apart.
The housing of the male connector slides to separate the cables.*

Connecting Cables:

**Slide
Connector Housing**

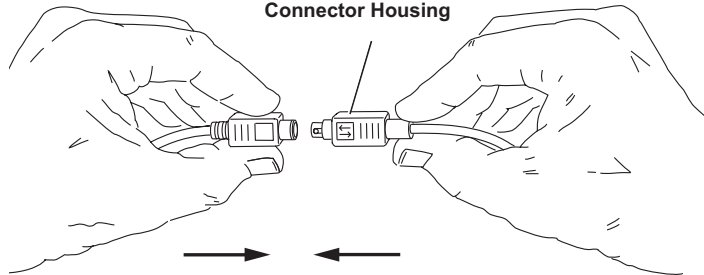

Hold the female connector and push the male connector from behind, allowing its housing to slide back. The cables lock together when a connection is made.

See the wiring diagrams below for more information:

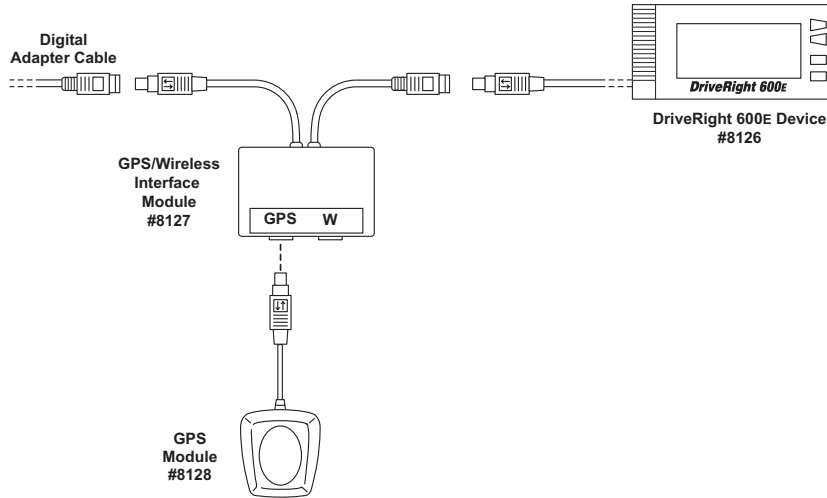

GPS/Wireless Interface Module to DriveRight Wiring Diagram

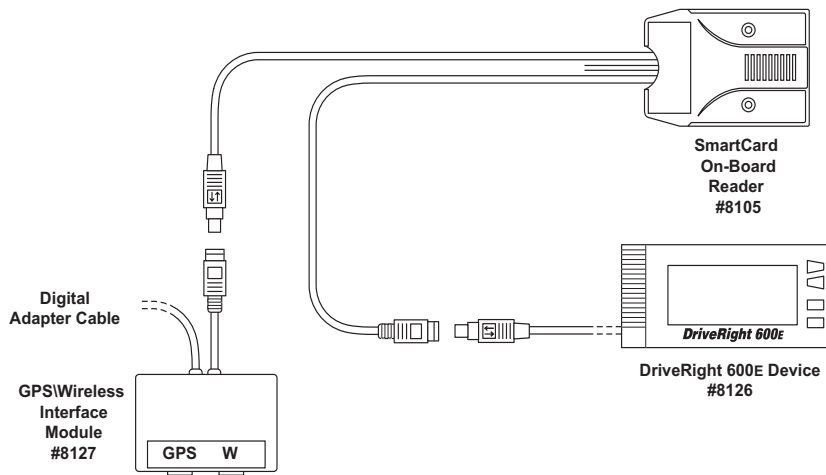

GPS/Wireless Interface Module to SmartCard On-Board Reader Wiring Diagram

Note: The GPS module must be enabled via the DriveRight Fleet Management Software for the module to function. See the *FMS Online Help System* for more information

GPS\Wireless Interface Module Specifications

Size 3.25" x 2.00" x 1.00" (97 mm x 61 mm x 23 mm)
Weight 11 oz (0.3 kg)
Operating Range -4°F to +140°F (-20°C to +60°C)
Storage Range -40°F to +185°F (-40°C to +85°C)
Input Power +12Vdc to +16 Vdc regulated, 100-250 mA
Memory Backup Lithium cell, estimated 5 year service life
Cable Connection/Length
 Module to adapter cable Male 8-pin Mini-DIN / 14" (355 mm)
 Module to DriveRight 600E Female 8-pin Mini-DIN / 24" (609 mm)

GPS Module Specifications

Size 2.38" x 2.38" x 1.00" (58 mm x 48 mm x 27 mm)
Weight 4.0 oz (0.113 kg)
Operating Range -22°F to +185°F (-30°C to +85°C)
Storage Range -40°F to +194°F (-40°C to +90°C)
Frequency 1575.42 MHz (L1)
Cable
 Length 78" (2 m)
 Connector 6-pin locking Mini-DIN

GPS Receiver Specifications

Channels 16
Frequency 1575.42 MHz (L1)
 Position <3 m
 Velocity 0.1 mph (0.05 m/s) typical
Dynamic Limits
 Acceleration 2 G max
 Jerk 4 m/s³
Startup Time To First Location Fix
 DriveRight unplugged for:
 0 hours 15 seconds
 More than 0, less than 4 hours . . . 40 seconds
 More than 4 hours 120 seconds
Re-Acquisition Time
 After 60 second obstruction 10 seconds
 Internal <1.0 seconds

Contacting Davis Technical Support

If you have questions or encounter problems installing or operating your GPS/Wireless Interface Module or GPS Module, please contact Davis Technical Support.

Note: Please do not return items to the factory for repair without prior authorization.

Phone Support

(510) 732-7814 – Monday - Friday, 7:00 a.m. - 5:30 p.m. Pacific Time.

(510) 670-0589 – Fax to Technical Support.

E-mail Support

support@davisnet.com – E-mail to Technical Support.

info@davisnet.com – E-mail to Davis Instruments.

Web Support

www.davisnet.com – Copies of User Manuals and Installation Manuals are available on the “Support” page. Watch for FAQs and other updates.